



TEXAS DEPARTMENT OF TRANSPORTATION



ITEM 7: US 181 HARBOR BRIDGE PROJECT

Texas Transportation Commission



Project scope

- Develop, design, construct, maintain and finance a total project length of 6.44 miles.
- Base scope
 - New six-lane Harbor Bridge.
 - Six-lane sections of US Highway 181 (US 181).
 - Reconstruction of approximately 1.6 miles of Interstate Highway 37 (I-37).
 - Reconstruction of approximately 1 mile of Crosstown Expressway (SH 286).
 - Demolition of the existing Harbor Bridge.
- Option work
 - #1 - Broadway Boulevard from Harbor Drive to I-37 (Requested by the City of Corpus Christi).
 - #2 -Transition of I-37 to a low-speed arterial street from the SH 286/US 181 Interchange to Mesquite Street.
- 25-year Operation and maintenance life-cycle contract.
- \$984M identified in the Funding Plan.



Public outreach

- 4 public/agency scoping meetings from 2005 to 2011.
- 6 meetings of the Citizen Advisory Committee from 2011 to 2014.
- 5 meetings of the Technical Advisory Committee from 2011 to 2014.
- 8 neighborhood meetings prior to the DEIS in 2012.
- 8 additional neighborhood meetings prior to the public hearing in 2014.
- 2 public meetings with the City of Corpus Christi for park mitigation in 2013.
- 1 public meeting in 2012.
- Public hearing held February 18, 2014, extended formal comment period.
- In response to requests, the public comment period was extended 30 days.

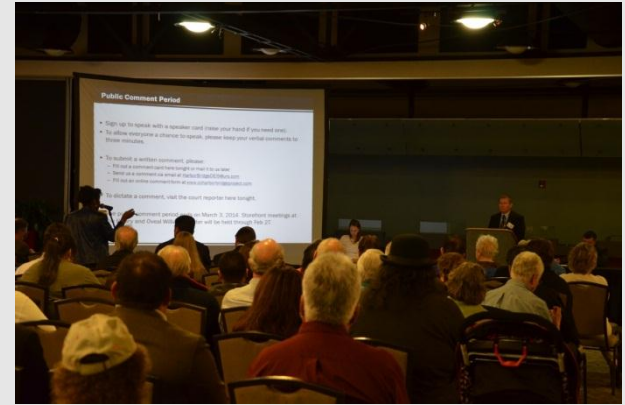

Corpus Christi public hearing, February 18, 2014

Public outreach

- 20 days of neighborhood storefront meetings during DEIS public review period:
 - La Retama Central Public Library.
 - Oveal Williams Senior Center.
- Early coordination on environmental justice mitigation to include:
 - Livability summit hosted by FHWA and CC MPO in October 2014.
 - Currently Developing a livability plan for the Northside neighborhood working with FHWA.
 - Two livability workshops were conducted early 2015, with additional workshops before 2016.
 - “The History Project” involved testimonials from residents, historical photos documenting the history of the neighborhoods.



Public outreach and livability workshops

Public outreach

Multiple stakeholder meetings throughout the project

- EPA Summit EJ Interagency Workgroup
- North Beach HOA
- Bicycle/Pedestrian Committee
- Rotary, Kiwanis Club
- Black Chamber of Commerce
- Hispanic Chamber of Commerce
- Northside Neighborhood Association
- Corpus Christi MPO
- Port of Corpus Christi
- Westside Business Association
- Kelsey Memorial Methodist Church
- United Way of the Coastal Bend
- Spohn Health Care System



Public outreach and livability workshops

US 181 Harbor Bridge aesthetics — Blue Ribbon Panel

- “Blue Ribbon Panel” meetings to develop aesthetics requirements
 - February 19 and April 16, 2014
- Blue Ribbon Panel Members
 - Nelda Martinez, Corpus Christi Mayor
 - Judy Hawley, Port of Corpus Christi Commission Chair
 - Terry Simpson, San Patricio County Judge
 - Loyd Neal, Nueces County Judge
- Aesthetics requirements of the panel were provided to proposers.
- Aesthetics Subcommittee evaluated proposals based upon requirements in the RFP.
- Sustainability Plan – FHWA “INVEST” program *platinum* rating.



Aesthetics Subcommittee Meeting
April 14, 2015

Submitted proposals — Flatiron/Dragados USA, JV*

Equity members

- Flatiron Constructors, Inc. (50%)
- Dragados USA, Inc. (50%)

Major non-equity members and other team members

- AIA Engineers, Ltd.
- Figg Bridge Engineers, Inc.
- Iridium Concesiones de Infraestructuras, S.A. (acting through ACS Infrastructure Development, Inc.)
- DBI Services, LLC
- Austin Bridge & Road, LP
- AZTEC Engineering Group, Inc.
- Beton Consulting Engineers, LLC
- Blanton & Associates, Inc.
- D.H. Griffin of Texas, Inc.
- IEA, Inc.
- Kellogg, Brown & Root Services, Inc.
- KCI Technologies, Inc.
- M2L Associates Inc.
- PaveTex Engineering and Testing, Inc.
- Pinnacle Consulting Management Group, Inc.
- Professional Service Industries, Inc.
- Randy Burkett Lighting Design, Inc.
- RJ Rivera Associates, Inc.
- The Boundary Layer Wind Tunnel Laboratory (as represented by The University of Western Ontario)
- Ware & Associates, Inc.

**alphabetical order*

Submitted proposals — Harbor Bridge Constructors*

Equity members

- Walsh Infrastructure, LLC (100%)
- Walsh Investors, LLC (sole member of Walsh Infrastructure, LLC)

Major non-equity members and other team members

- Archer Western/Granite JV
- Archer Western Construction, LLC
- Granite Construction Company
- HDR Engineering, Inc.
- Infrastructure Corporation of America
- Applied Research Associates, Inc.
- B2Z Engineering
- Bridgescape, LLC
- Genesis Structures, Inc.
- Hinman Consulting Engineers, Inc.
- Illumination Arts, LLC
- International Bridge Technologies, Inc.
- INTERA Incorporated
- KTA-Tator, Inc.
- Maldonado-Burkett Intelligent Transportation Systems, LLP
- Michael Baker Jr., Inc.
- Olivarri & Associates, Inc.
- Rodriguez Transportation Group, Inc.
- RODS Surveying, Inc.
- RVE, Inc.
- Shannon & Wilson, Inc.
- Solaray Engineering, Inc.
- Stateside Right of Way Services, LLC
- STL Engineers
- Structural Engineering Associates, Inc.
- West Wind Laboratory, Inc.
- Wiss, Janey, Elstner

**alphabetical order*

Submitted proposals – Harbor Bridge Partners*

Equity member

- Kiewit Development Company

Major non-equity members and other team members

- Buckland & Taylor
- J.D. Abrams, L.P.
- Lamb-Star Engineering, L.P.
- Miller Paving Limited
- Parsons Brinkerhoff, Inc.
- AIA Engineers, Ltd.
- Alta Vista Solutions
- CSJ Utility Coordinators, LLC
- Gunda Corporation, LLC
- IDCUS dba IDC Inc.
- Lymon C. Reese & Associates
- Olivarri & Associates Inc.
- Rowan Williams Davies & Irwin Inc.
- Tolunay-Wong Engineers, Inc.
- Touchstone Architecture & Consulting, P.A.
- The Transtec Group, Inc.
- Universal Field Services, Inc.

**alphabetical order*

Submitted proposals — Traylor-Zachry-Fluor Crosstown Builders*

Equity members

- TZF Crosstown Constructors, LLC.
 - Traylor Bros., Inc. (35%)
 - Zachry Construction Corporation (35%)
 - Fluor Enterprises, Inc. (30%)
- TZF Crosstown Maintenance, LLC.
 - Traylor Bros., Inc. (10%)
 - Zachry Construction Corporation (10%)
 - Fluor Enterprises, Inc. (80%)

Major non-equity members

- TYLI-PTG, JV
- T.Y. Lin International
- Parsons Transportation Group, Inc.

Other team members

- Arias & Associates, Inc.
- Bridgefarmer & Associates, Inc.
- Cobb, Fendley & Associates, Inc.
- Corsair Consulting LLC
- Cox McLain Environmental Consulting, Inc.
- CTLGroup
- Dan Brown and Associates, PC

- Fugro Consultants, Inc.
- Illumination Arts, LLC.
- Infrastructure Corporation of America
- Karagozian & Case, Inc.
- Martinez, Guy & Maybik, Inc.
- Morehead Dotts Rybak
- Norton Corrosion Limited
- Rowan Williams Davies & Irwin, Inc.
- RVi Planning
- Volkert, Inc.
- Ximenes & Associates, Inc.

**alphabetical order*

Evaluation of proposals

Evaluation process

- Implemented a pre-established and rigorous procedure to evaluate and select the proposal that offers the best value.
- Separate pass/fail, technical/aesthetic, and price subcommittees.
- Subcommittees were separate and unaware of other committees' scores.
- Evaluations were compiled and tallied by each subcommittee and recommendations made to TxDOT administration regarding a final score and then to Commission for consideration.



Apparent best value determination

- Price includes design, construction and maintenance.
- Technical and aesthetics score is based upon:
 - Aesthetic requirements.
 - Technical solutions.
 - Project management plan.
 - Quality management plan.
 - Maintenance management plan.
 - Sustainability plan.

Best Value Scoring:

Price	80 points
+ Technical including aesthetics	20 points
<hr/>	
Maximum	100 points

Apparent best value = Highest total proposal score

Detailed evaluations resulting in...

Flatiron/Dragados USA, JV

- **Equity owner:** Flatiron Constructors, Inc.
Dragados USA, Inc.

Major non-equity members and other team members:

- AIA Engineers, Ltd.
- Figg Bridge Engineers, Inc.
- Iridium Concesiones de Infraestructuras, S.A.
(acting through ACS Infrastructure Development, Inc.)
- DBI Services, LLC
- Austin Bridge & Road, LP
- AZTEC Engineering Group, Inc.
- Beton Consulting Engineers, LLC
- Blanton & Associates, Inc.
- D.H. Griffin of Texas, Inc.
- IEA, Inc
- Kellogg, Brown & Root Services, Inc.
- KCI Technologies, Inc.
- M2L Associates Inc.
- PaveTex Engineering and Testing, Inc.
- Pinnacle Consulting Management Group, Inc.
- Professional Service Industries, Inc.
- Randy Burkett Lighting Design, Inc.
- RJ Rivera Associates, Inc.
- The Boundary Layer Wind Tunnel Laboratory
(as represented by The University of Western Ontario)
- Ware & Associates, Inc

Evaluation Results Summary

- **Flatiron/Dragados JV.....93.74 pts**
- **Crosstown Builders (Traylor/Zachry/Fluor).....92.25 pts**
- **Harbor Bridge Constructors (Walsh).....87.84 pts**
- **Harbor Bridge Partners (Kiewit).....74.18 pts**

Best value proposer

Base Scope D&C Price	\$ 845,150,246.60
Option 1 Price	\$ 7,394,266.40
Option 2 Price	\$ 2,039,892.07
Total D&C Price	\$ 854,584,405.07 (nominal)

Best value proposer

O&M Base Scope Price	\$128,342,441.48
O&M Option 2 Price	(\$141,339.40)
Total Price	\$128,201,102.08 (NPV)

Aesthetics

- Shared Use Path
- Bridge/Pedestrian Belvedere
- Lighting Concept
- Exotic Bridge Structure

LANDSCAPING & CONNECTIVITY KEY

- S** Shared Use Path Entrance to Bridge
- T** Trailhead
- Shared Use Path (Hike/Bike)
- City Mobility Plan Path
- Landscape Areas
- Existing Park

CREATING COMMUNITY CONNECTIVITY

LANDSCAPE DESIGN INSPIRED BY COASTAL BEAUTY

The landscape design will complement all aspects of mobility – automobile, transit, and pedestrian – to enhance community connectivity.

- Create landscaped gateways,
- Connect community parks,
- Complement the City's mobility plan
- Connect the community
- Enhance the City's "Sense of Place"
- Provide community recreation areas for local neighborhoods
- Provide safe and attractive entrance/exit locations for the shared use path
- Utilize xeriscape native vegetation
- Celebrate the movement of nature seen in waves, animal life, and wind through the sweeping forms of plants, benches, and walls.
- Integrate local streets into the landscape

1 I-37 @ US 181 intersection

2 BROADWAY MEDIAN (74 feet WIDE)

3 SH 286 @ Broadway

1 I-37 @ US 181 intersection

2 SH 286 @ Broadway

Aesthetics

- Shared Use Path
- Bridge/Pedestrian Belvedere
- Lighting Concept
- Exotic Bridge Structure

LANDSCAPING & CONNECTIVITY KEY

- Shared Use Path Entrance to Bridge
- Trailhead
- Shared Use Path (Hiker/Biker)
- City Mobility Plan Path
- Landscape Area
- Existing Park

CREATING COMMON LANDSCAPE DESIGN INSPIRED BY COASTAL BEACHES

The landscape design will complement all aspects of mobility – automobile, transit, and pedestrian – to enhance community connectivity.

- Create landscaped gateways.
- Connect community parks.
- Complement the City's mobility plan
- Enhance the City's "Sense of Place"
- Provide community recreation areas for local neighborhoods
- Provide safe and attractive entrance/exit locations for the shared use path
- Utilize xeriscap native vegetation
- Celebrate the movement of nature seen in waves, animal life, and wind through the sweeping forms of plants, benches, and walls.
- Integrate local streets into the landscape

1 I-37 @ US 181

2 SH 286 @ Broadway

3 BROADWAY MEDIAN (74 feet WIDE)

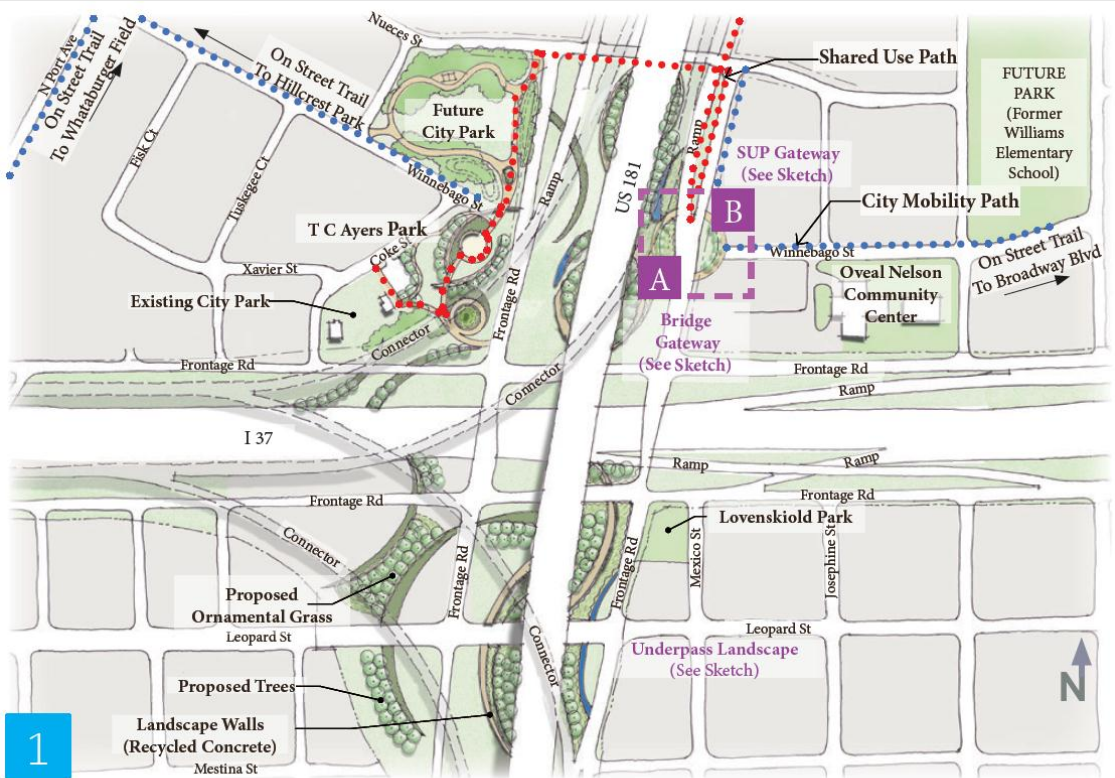

I-37 @ US 181 intersection

Aesthetics

- Shared Use Path
- Bridge/Pedestrian Belvedere
- Lighting Concept
- Exotic Bridge Structure

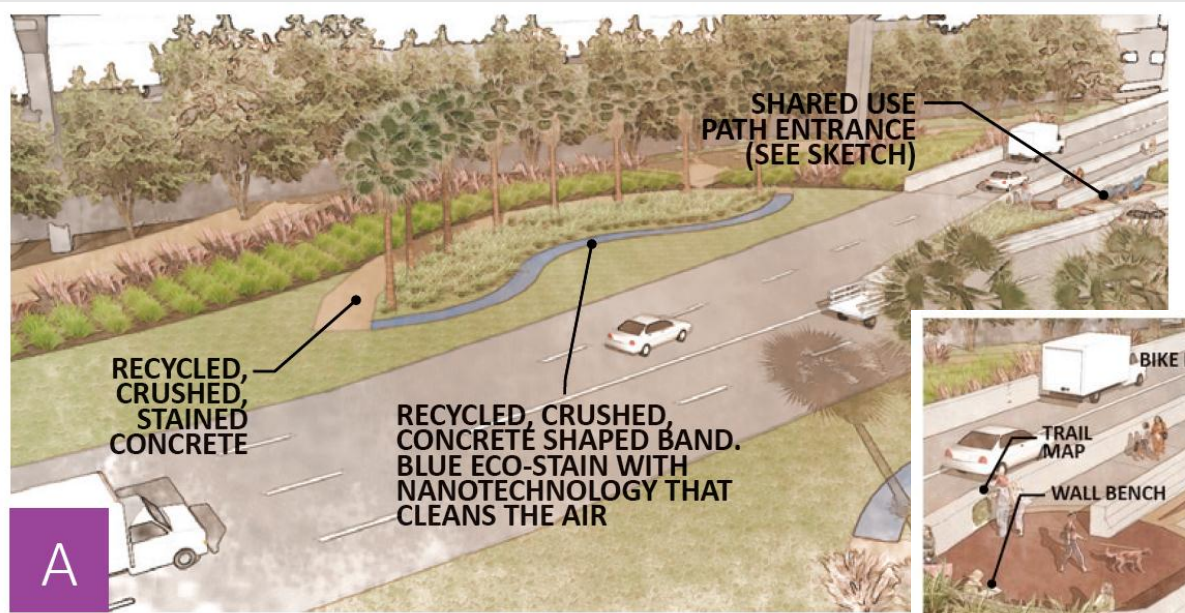
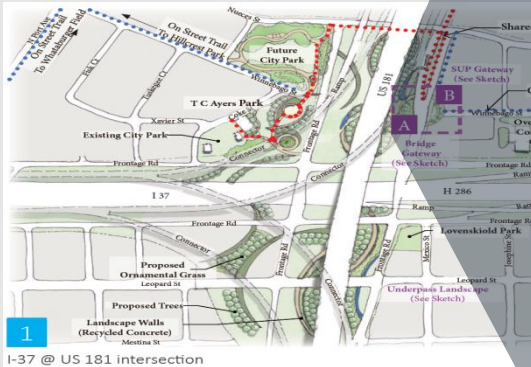

NORTHBOUND BRIDGE LANDSCAPE GATEWAY

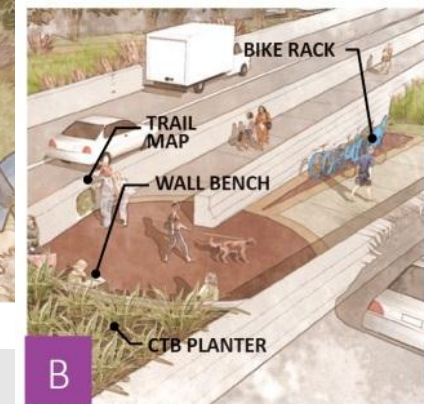

SOUTH BRIDGE SHARED USE PATH GATEWAY ENTRANCE

Aesthetics

- Shared Use Path
- Bridge/Pedestrian Belvedere
- Lighting Concept
- Exotic Bridge Structure

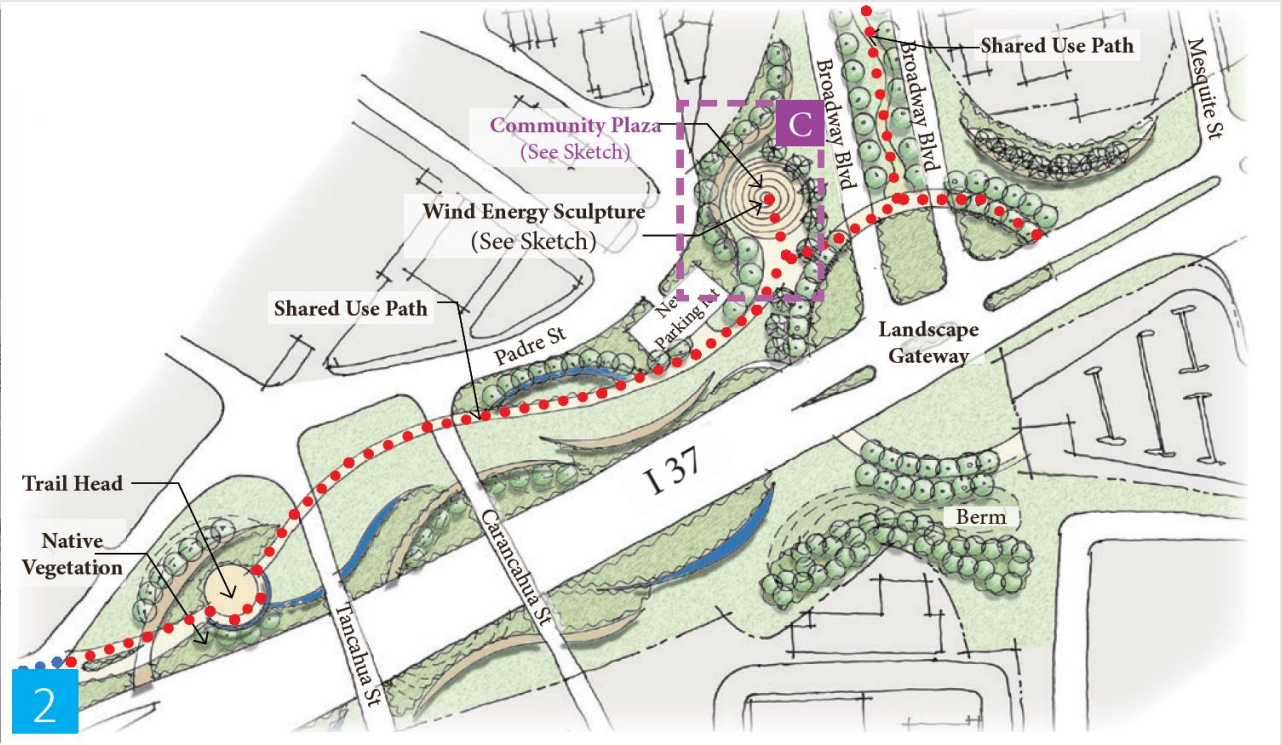

Aesthetics

- Shared Use Path
- Bridge/Pedestrian Belvedere
- Lighting Concept
- Exotic Bridge Structure

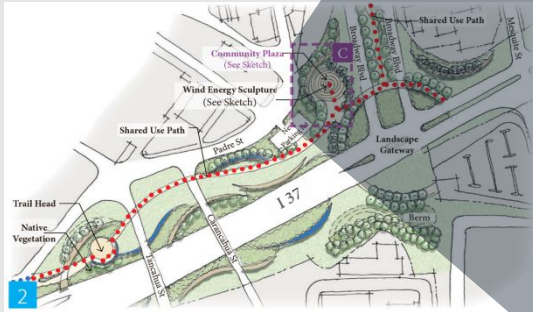

COMMUNITY PLAZA CONCEPT



Aesthetics

- Shared Use Path
- Bridge/Pedestrian Belvedere
- Lighting Concept
- Exotic Bridge Structure



Aesthetics

- Shared Use Path
- Bridge/Pedestrian Belvedere
- Lighting Concept
- Exotic Bridge Structure

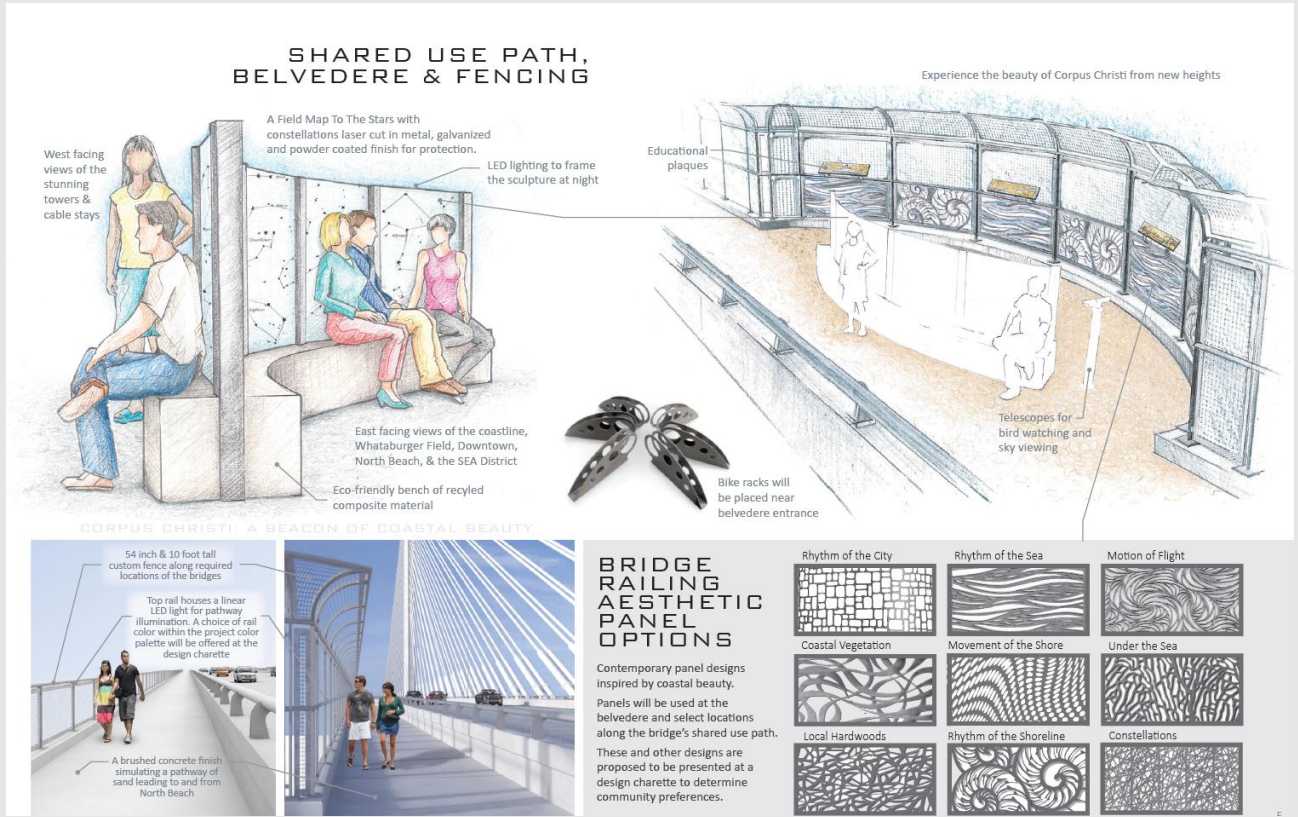

Aesthetics

- Shared Use Path
- Bridge/Pedestrian Belvedere
- Lighting Concept
- Exotic Bridge Structure

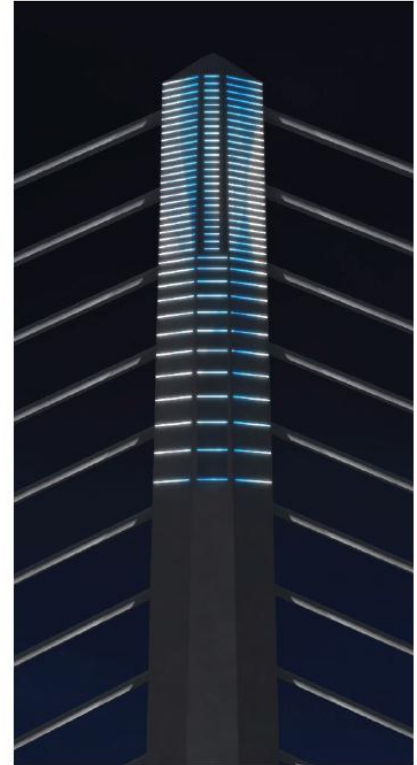
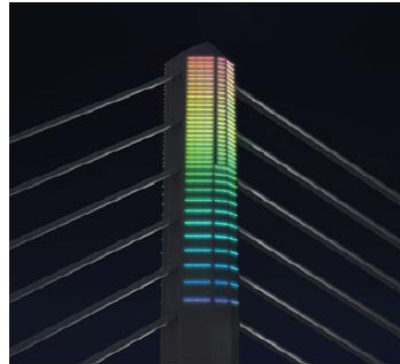

Aesthetics

- Shared Use Path
- Bridge/Pedestrian Belvedere
- Lighting Concept
- Exotic Bridge Structure



Aesthetics

- Shared Use Path
- Bridge/Pedestrian Belvedere
- Lighting Concept
- Exotic Bridge Structure



Special thanks to our project champions

- **State Legislators**
 - Senator Juan Hinojosa
 - Representative Abel Herrero
 - Representative Todd Hunter
- **Counties**
 - Judge Loyd Neal
 - Judge Terry Simpson
- **City of Corpus Christi**
 - Mayor Nelda Martinez
- **Port of Corpus Christi**
 - Chairman Judy Hawley



Evaluation team

- **TxDOT Chief Planning and Projects Officer**
 - Russell Zapalac
- **Ex Officio Members**
 - James Bass, CFO
 - Bill Hale, Chief Engineer
- **TxDOT Strategic Projects Division**
 - Katie Nees
 - Dieter Billek
 - Mike Midkiff
 - Scott Spradlin
 - Matt McCarter
 - Jeannie Arellano
 - Frank Holzmann
 - Carol Luschen
 - Randy Grones
- **TxDOT Office of General Counsel**
 - Jim Bailey
 - Claire McGuinness
- **TxDOT Debt Management Office**
 - Benjamin Asher
 - Deborah Fleming
 - Sara Chapa
 - Glen Knipstein
- **TxDOT District Office**
 - Lonnie Gregorcyk
 - Chris Caron
 - Valente Olivarez
 - Victor Vourcos
 - Christopher Amy
 - Tomas Trevino
 - Martin Horst
- **TxDOT Division Offices**
 - Bernie Carrasco (Bridge)
 - Jamie Farris (Bridge)
 - Graham Bettis (Bridge)
 - John Delphia (Bridge)
 - Gregg Freeby (Bridge)
 - Joe Leidy (Pavement)

Next steps

- Negotiate final terms of comprehensive development agreement.
- Legislative Budget Board approval.
- FHWA environmental approval.
- NTP 1 is expected Fall 2015 (contingent on environmental approval).
- Begin design/construction early 2016 (contingent on environmental approval).
- Substantial completion expected spring 2020.
- Final acceptance expected summer 2020.
- Final design and construction may begin only upon completion of the NEPA process.



Questions?

Staff recommends and requests Commission approval of this minute order:

To approve the Executive Director to negotiate and execute the Contract including O&M, Option #2 and Option #1, should local funding become available for Option #1.